

CROWN LAND PLANS

HyNet Carbon Dioxide Pipeline DCO

Planning Act 2008

The Infrastructure Planning (Applications: Prescribed Forms and Procedure) Regulations 2009 –
Regulations 5(2)(n)

Document Reference Number D.2.3

Applicant: Liverpool Bay CCS Limited

Inspectorate Reference: EN070007

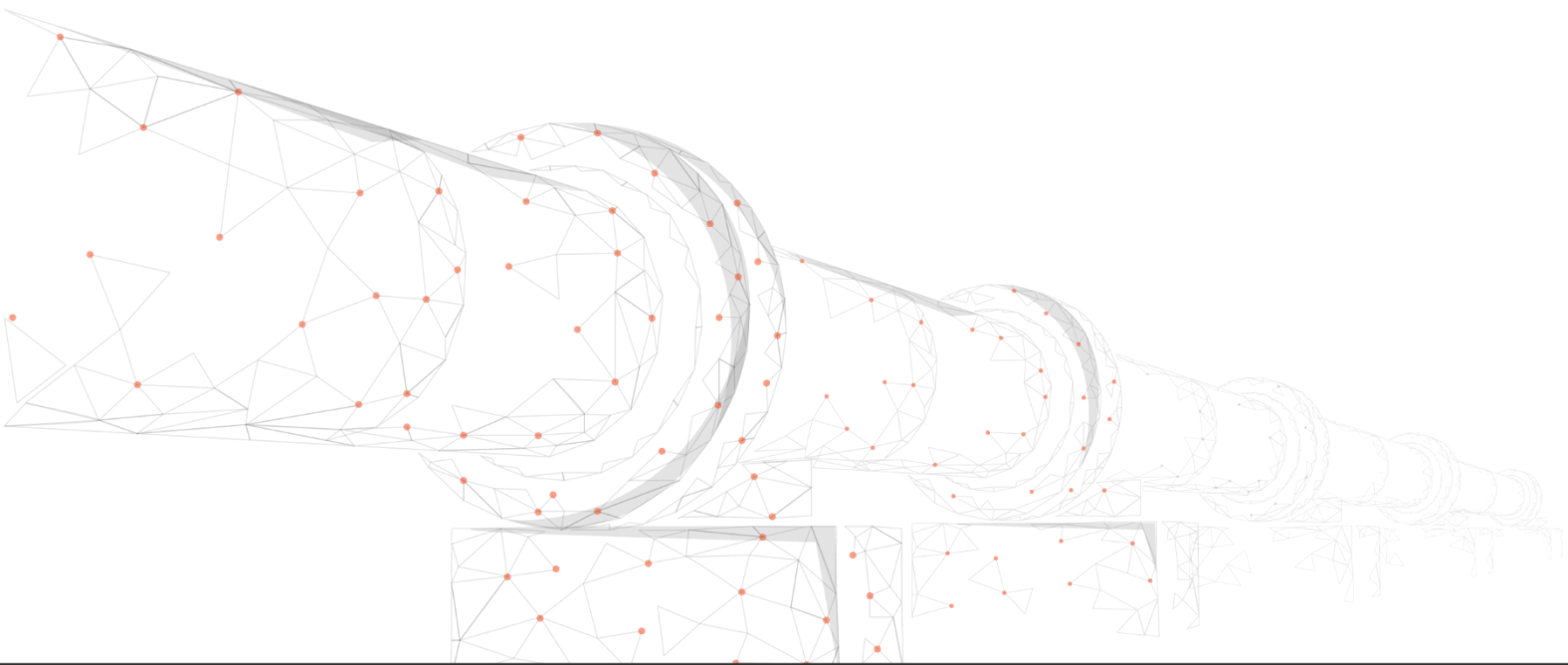

REVISION: F

DATE: July 2023

DOCUMENT OWNER: WSP UK Limited

PUBLIC

QUALITY CONTROL

Document Reference	D.2.3				
Document Owner	WSP				
Revision	Date	Comments	Author	Check	Approver
A	September 2022	Submitted with DCO application	PT	VB	AV
B	March 2022	S51	PT	VB	AV
C	March 2023	Change Request 1	PT	VB	AV
D	May 2023	Deadline 3	PT	VB	AV
E	June 2023	Deadline 4	PT	VB	AV
F	July 2023	Change Request 3	PT	VB	AV

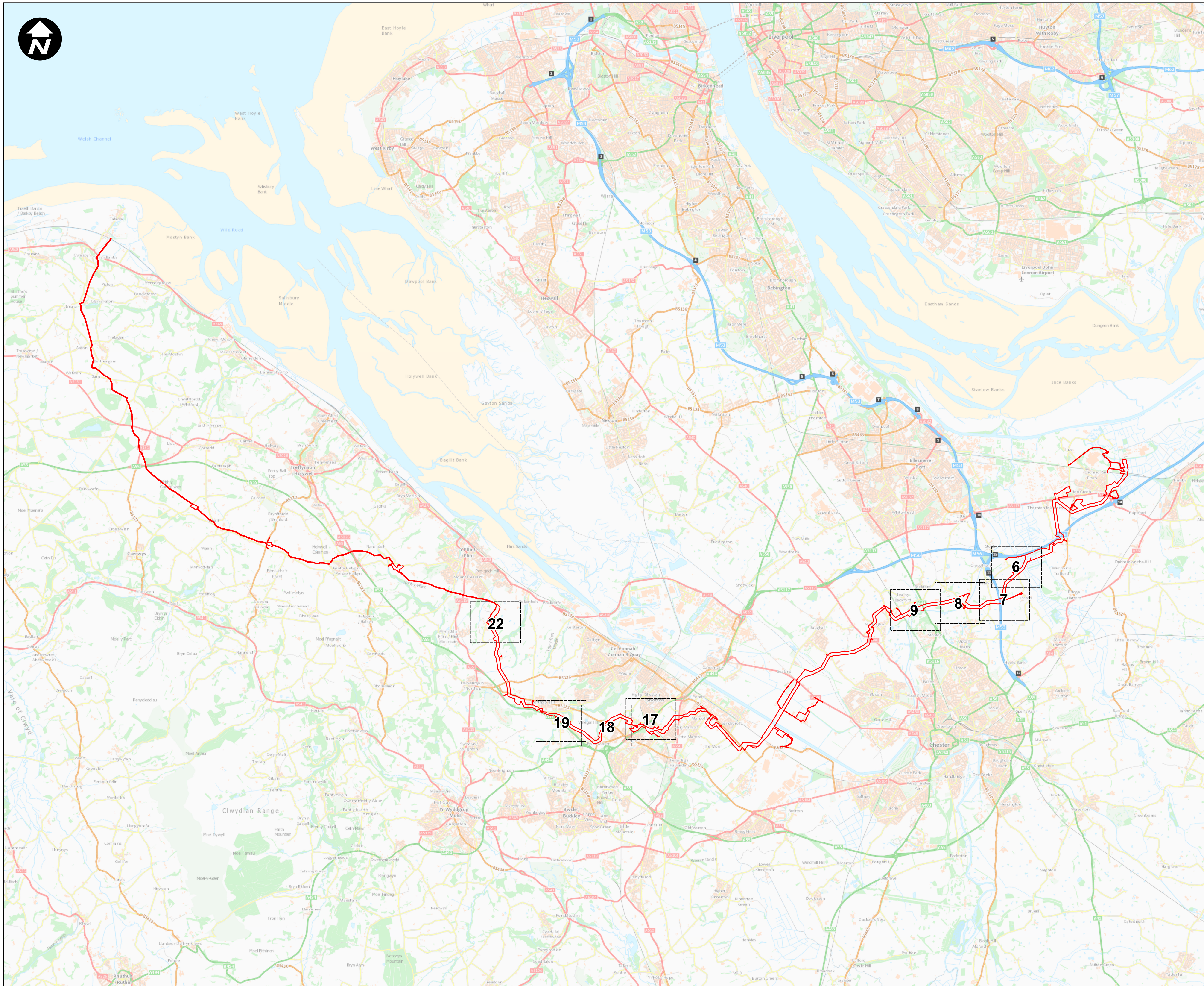

Service Layer Credits: Contains OS data © Crown Copyright and database right 2020 **1:750,000**

Key:
 Order Limits

1. All dimensions are in metres unless stated otherwise.
2. These Land Plans should be read in conjunction with other plans and documents in the Development Consent Order application in particular the Book of Reference.
3. All easements, servitudes and private rights in land are proposed to be extinguished on land shown coloured pink on these land plans. All easements, servitudes and private rights in land are proposed to be extinguished, so far as their continued exercise would be inconsistent with the exercise of the rights or restrictions proposed to be acquired by the undertaker on land shown coloured blue on these land plans. All easements, servitudes and private rights are proposed to be suspended while the undertaker is in temporary possession of the land shown coloured green on these land plans.
4. The number labels relate to plot numbers. Please refer to the Book of Reference for more information about these plots, including the approximate area of each plot (in square metres). Plot numbers include a reference to the relevant sheet of the Land Plans. In this numbering convention, a plot number comprises the sheet number followed by the actual plot number, e.g: Plot 01-24, where '01' is the sheet number (sheet 1) and '24' is the plot number (24 on sheet 1).

F	JH	PT	VB	26/06/2023
E	JH	PT	VB	13/06/2023
D	NC	PT	VB	18/05/2023
C	RH	PT	VB	28/02/2023
B	NC	RB	VB	13/01/2023
A	PM	JH	VB	27/09/2022
REVISION	DRAWN	CHECKED	APPROVED	DATE

SCALE: 1:60,000
 0 2,500 5,000
 Metres

Mapping reproduced by permission of Ordnance Survey on behalf of HMSO
 Contains OS data © Crown Copyright and database right 2022

HyNet North West

PROJECT TITLE
HyNet Carbon Dioxide Pipeline DCO

DRAWING TITLE
 CROWN LAND PLANS REGULATION (5)(2)(n)
 APPLICATION DOCUMENT REFERENCE D.2.3
 KEY PLAN

DRAWING STATUS
CHANGE REQUEST 3

DRAWN	CHECKED	APPROVED	AUTHORISED
RH	PT	VB	AV
SCALE @ A1 SIZE		DATE	REVISION
1:60,000		26/06/2023	F

DRAWING NUMBER
 EN070007-D.2.3-CLP-Key Plan

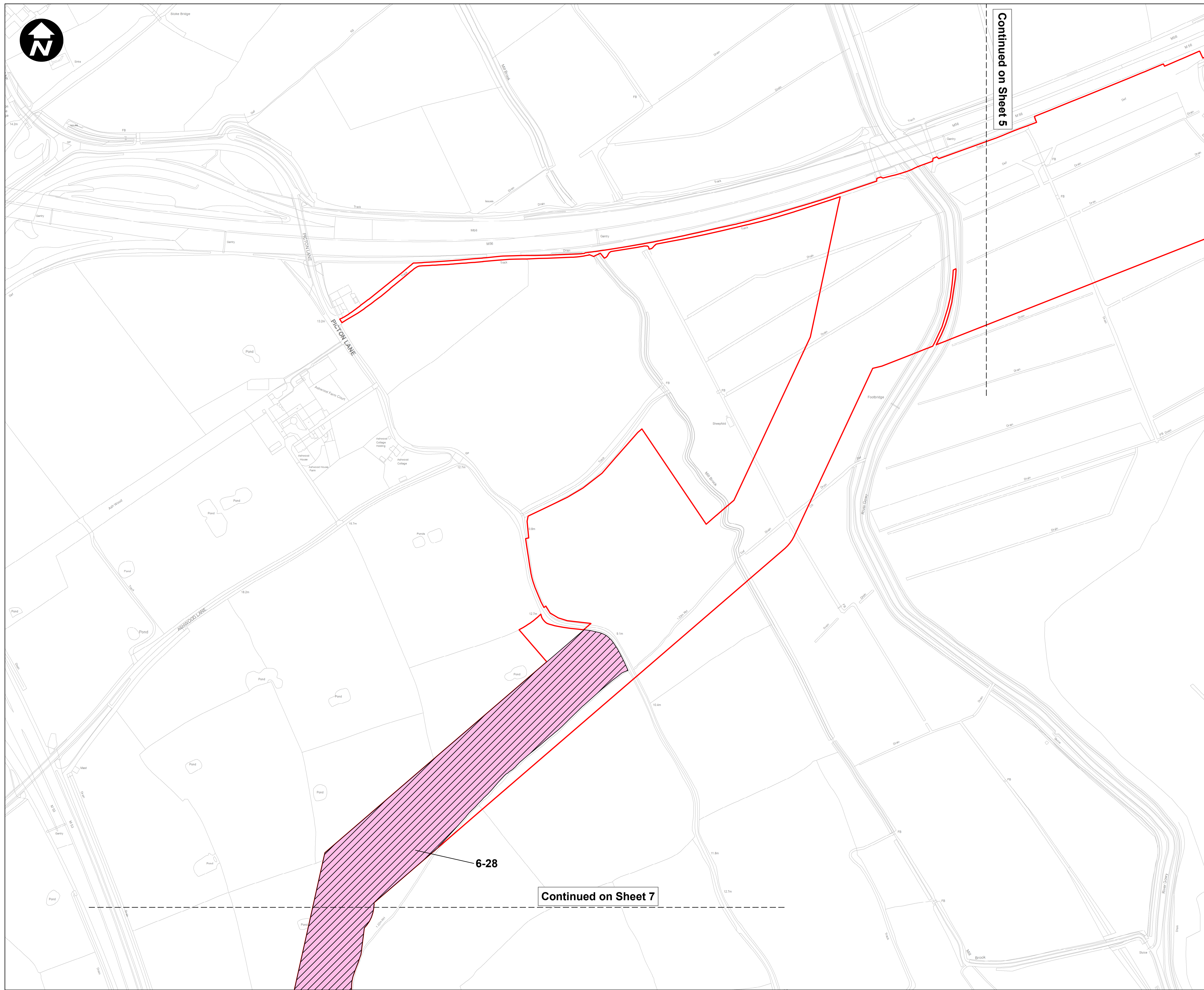

Continued on Sheet 5

Continued on Sheet 7

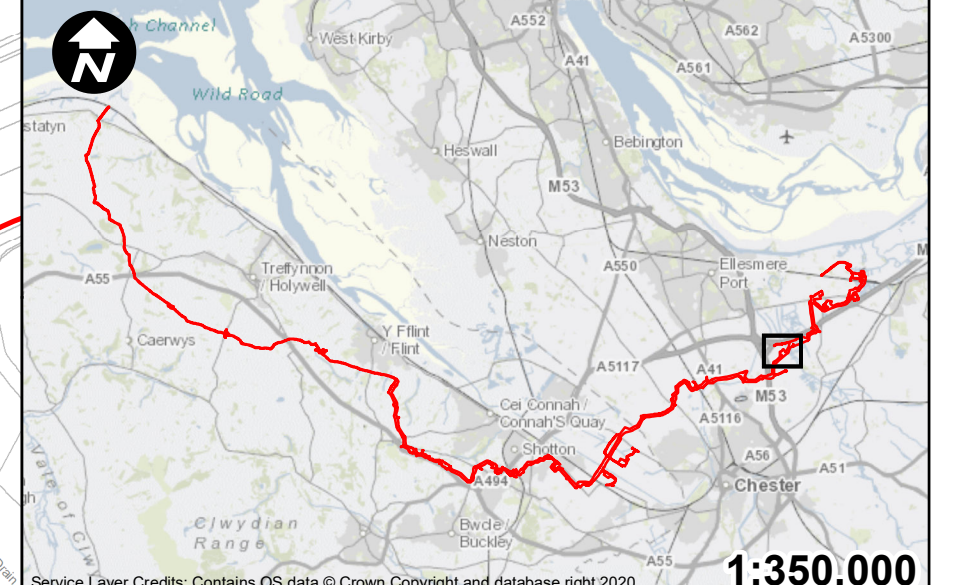

- Key:**
- Order Limits
 - Permanent acquisition of subsurface
 - Crown Land

1. All dimensions are in metres unless stated otherwise.
2. These Land Plans should be read in conjunction with other plans and documents in the Development Consent Order application in particular the Book of Reference.
3. All easements, servitudes and private rights in land are proposed to be extinguished on land shown coloured pink on these land plans. All easements, servitudes and private rights in land are proposed to be extinguished, so far as their continued exercise would be inconsistent with the exercise of the rights or restrictions proposed to be acquired by the undertaker on land shown coloured blue on these land plans. All easements, servitudes and private rights are proposed to be suspended while the undertaker is in temporary possession of the land shown coloured green on these land plans.
4. The number labels relate to plot numbers. Please refer to the Book of Reference for more information about these plots, including the approximate area of each plot (in square metres). Plot numbers include a reference to the relevant sheet of the Land Plans. In this numbering convention, a plot number comprises the sheet number followed by the actual plot number, e.g: Plot 01-24, where '01' is the sheet number (sheet 1) and '24' is the plot number (24 on sheet 1).

F	JH	PT	VB	26/06/2023
E	SA	PT	VB	13/06/2023
D	NC	PT	VB	18/05/2023
C	RH	PT	VB	28/02/2023
B	NC	RB	VB	13/01/2023
A	PM	JH	VB	27/09/2022
REVISION	DRAWN	CHECKED	APPROVED	DATE

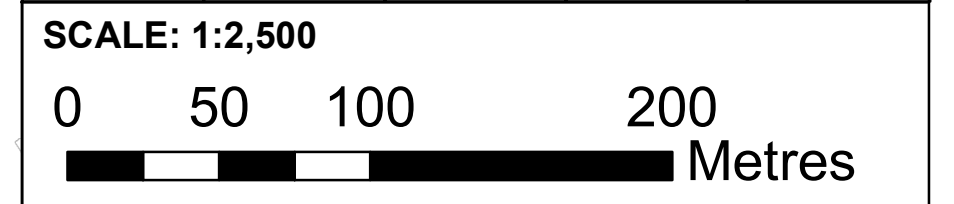

Mapping reproduced by permission of Ordnance Survey on behalf of HMSO
 Contains OS data © Crown Copyright and database right 2022

HyNet North West

PROJECT TITLE
HyNet Carbon Dioxide Pipeline DCO

DRAWING TITLE
 CROWN LAND PLANS REGULATION (5)(2)(n)
 APPLICATION DOCUMENT REFERENCE D.2.3
 SHEET 6

DRAWING STATUS
CHANGE REQUEST 3

DRAWN RH	CHECKED PT	APPROVED VB	AUTHORISED AV
SCALE @ A1 SIZE 1:2,500		DATE 26/06/2023	REVISION F

DRAWING NUMBER
 EN070007-D.2.3-CLP-Sheet 6

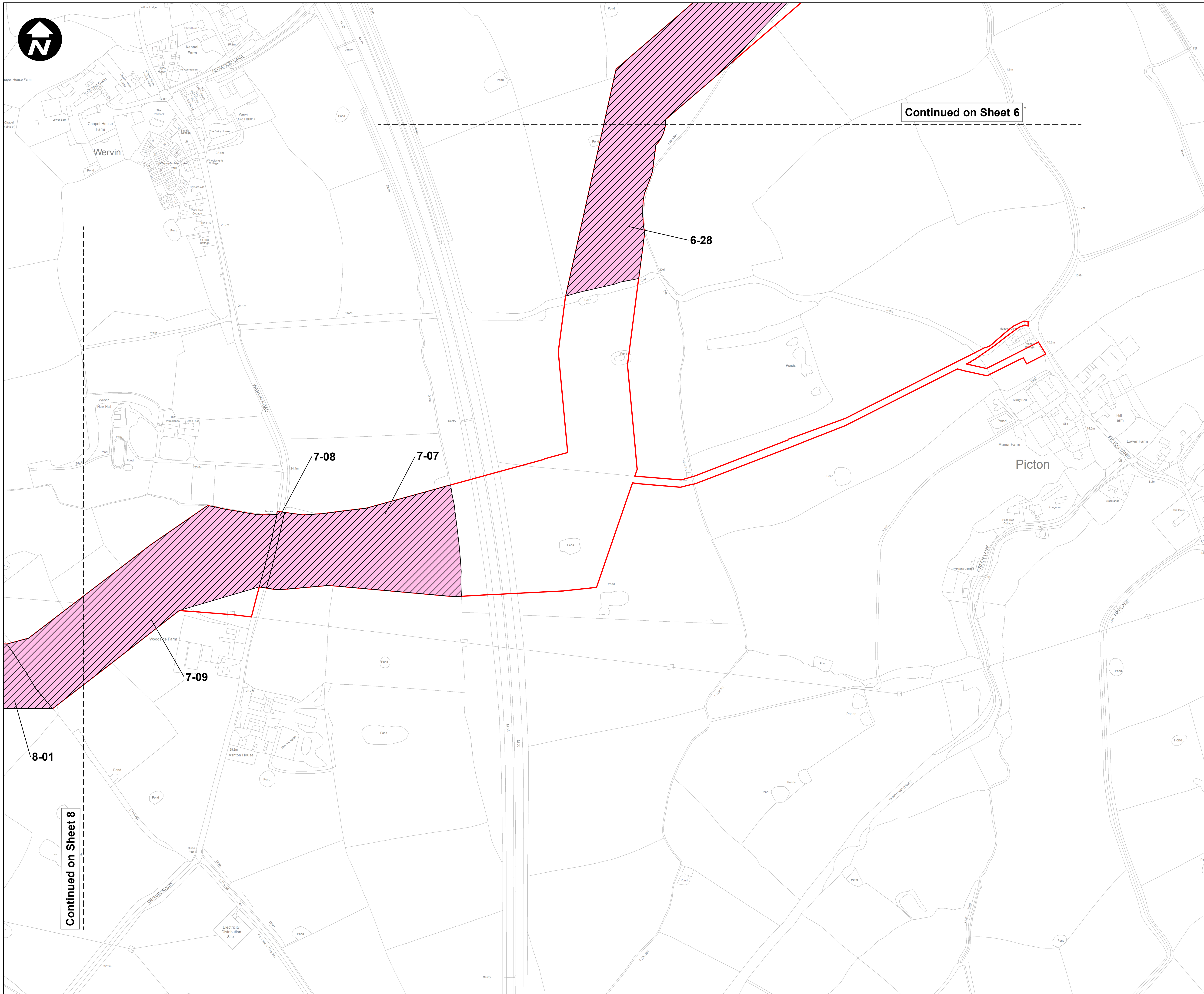

Continued on Sheet 6

Continued on Sheet 8

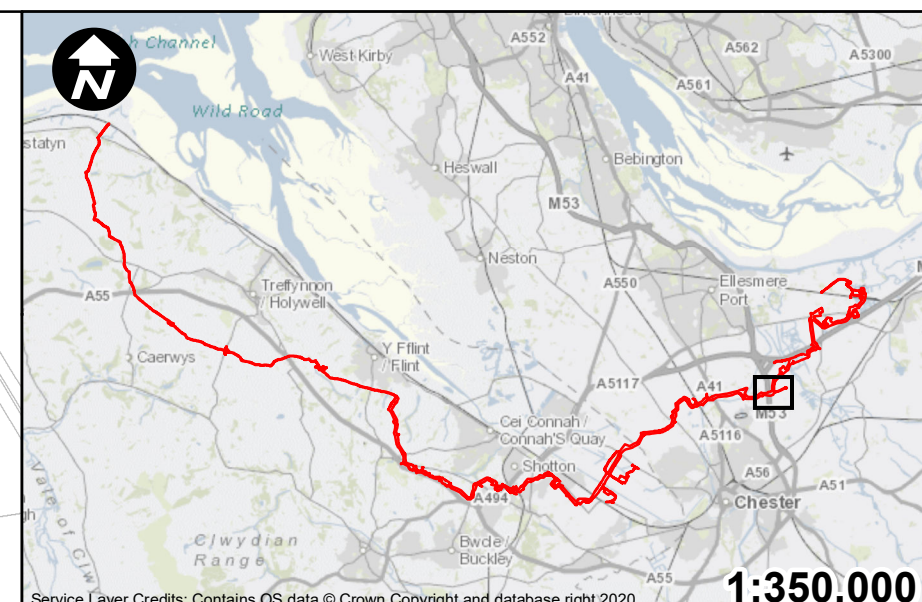

Key:

- Order Limits
- Permanent acquisition of subsurface
- Crown Land

1. All dimensions are in metres unless stated otherwise.
2. These Land Plans should be read in conjunction with other plans and documents in the Development Consent Order application in particular the Book of Reference.
3. All easements, servitudes and private rights in land are proposed to be extinguished on land shown coloured pink on these land plans. All easements, servitudes and private rights in land are proposed to be extinguished, so far as their continued exercise would be inconsistent with the exercise of the rights or restrictions proposed to be acquired by the undertaker on land shown coloured blue on these land plans. All easements, servitudes and private rights are proposed to be suspended while the undertaker is in temporary possession of the land shown coloured green on these land plans.
4. The number labels relate to plot numbers. Please refer to the Book of Reference for more information about these plots, including the approximate area of each plot (in square metres). Plot numbers include a reference to the relevant sheet of the Land Plans. In this numbering convention, a plot number comprises the sheet number followed by the actual plot number, e.g: Plot 01-24, where '01' is the sheet number (sheet 1) and '24' is the plot number (24 on sheet 1).

F	JH	PT	VB	26/06/2023
E	SA	PT	VB	13/06/2023
D	NC	PT	VB	18/05/2023
C	RH	PT	VB	28/02/2023
B	NC	RB	VB	13/01/2023
A	PM	JH	VB	27/09/2022
REVISION	DRAWN	CHECKED	APPROVED	DATE

SCALE: 1:2,500

Mapping reproduced by permission of Ordnance Survey on behalf of HMSO
 Contains OS data © Crown Copyright and database right 2022

HyNet North West

PROJECT TITLE
HyNet Carbon Dioxide Pipeline DCO

DRAWING TITLE
 CROWN LAND PLANS REGULATION (5)(2)(n)
 APPLICATION DOCUMENT REFERENCE D.2.3
 SHEET 7

DRAWING STATUS
CHANGE REQUEST 3

DRAWN RH	CHECKED PT	APPROVED VB	AUTHORISED AV
SCALE @ A1 SIZE 1:2,500		DATE 26/06/2023	REVISION F

DRAWING NUMBER
 EN070007-D.2.3-CLP-Sheet 7

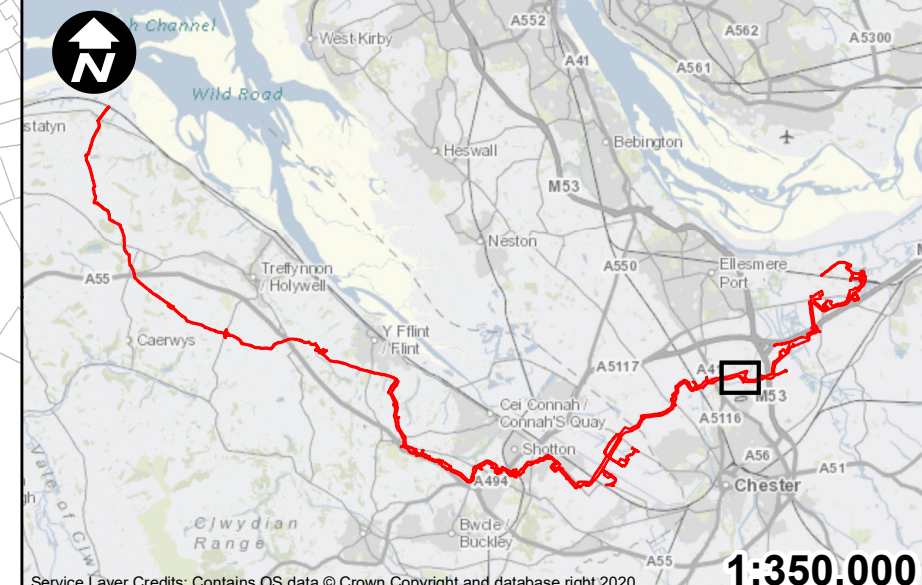

Service Layer Credits: Contains OS data © Crown Copyright and database right 2020

1:350,000

- Key:**
- Order Limits
 - Permanent acquisition of subsurface
 - Temporary possession of land
 - Crown Land

1. All dimensions are in metres unless stated otherwise.
2. These Land Plans should be read in conjunction with other plans and documents in the Development Consent Order application in particular the Book of Reference.
3. All easements, servitudes and private rights in land are proposed to be extinguished on land shown coloured pink on these land plans. All easements, servitudes and private rights in land are proposed to be extinguished, so far as their continued exercise would be inconsistent with the exercise of the rights or restrictions proposed to be acquired by the undertaker on land shown coloured blue on these land plans. All easements, servitudes and private rights are proposed to be suspended while the undertaker is in temporary possession of the land shown coloured green on these land plans.
4. The number labels relate to plot numbers. Please refer to the Book of Reference for more information about these plots, including the approximate area of each plot (in square metres). Plot numbers include a reference to the relevant sheet of the Land Plans. In this numbering convention, a plot number comprises the sheet number followed by the actual plot number, e.g: Plot 01-24, where '01' is the sheet number (sheet 1) and '24' is the plot number (24 on sheet 1).

F	JH	PT	VB	26/06/2023
E	SA	PT	VB	13/06/2023
D	NC	PT	VB	18/05/2023
C	RH	PT	VB	28/02/2023
B	NC	RB	VB	13/01/2023
A	PM	JH	VB	27/09/2022
REVISION	DRAWN	CHECKED	APPROVED	DATE

SCALE: 1:2,500

Mapping reproduced by permission of Ordnance Survey on behalf of HMSO
 Contains OS data © Crown Copyright and database right 2022

HyNet North West

PROJECT TITLE
HyNet Carbon Dioxide Pipeline DCO

DRAWING TITLE
 CROWN LAND PLANS REGULATION (5)(2)(n)
 APPLICATION DOCUMENT REFERENCE D.2.3
 SHEET 8

DRAWING STATUS
CHANGE REQUEST 3

DRAWN	CHECKED	APPROVED	AUTHORISED
RH	PT	VB	AV
SCALE @ A1 SIZE		DATE	REVISION
1:2,500		26/06/2023	F

DRAWING NUMBER
 EN070007-D.2.3-CLP-Sheet 8

Continued on Sheet 7

Continued on Sheet 9

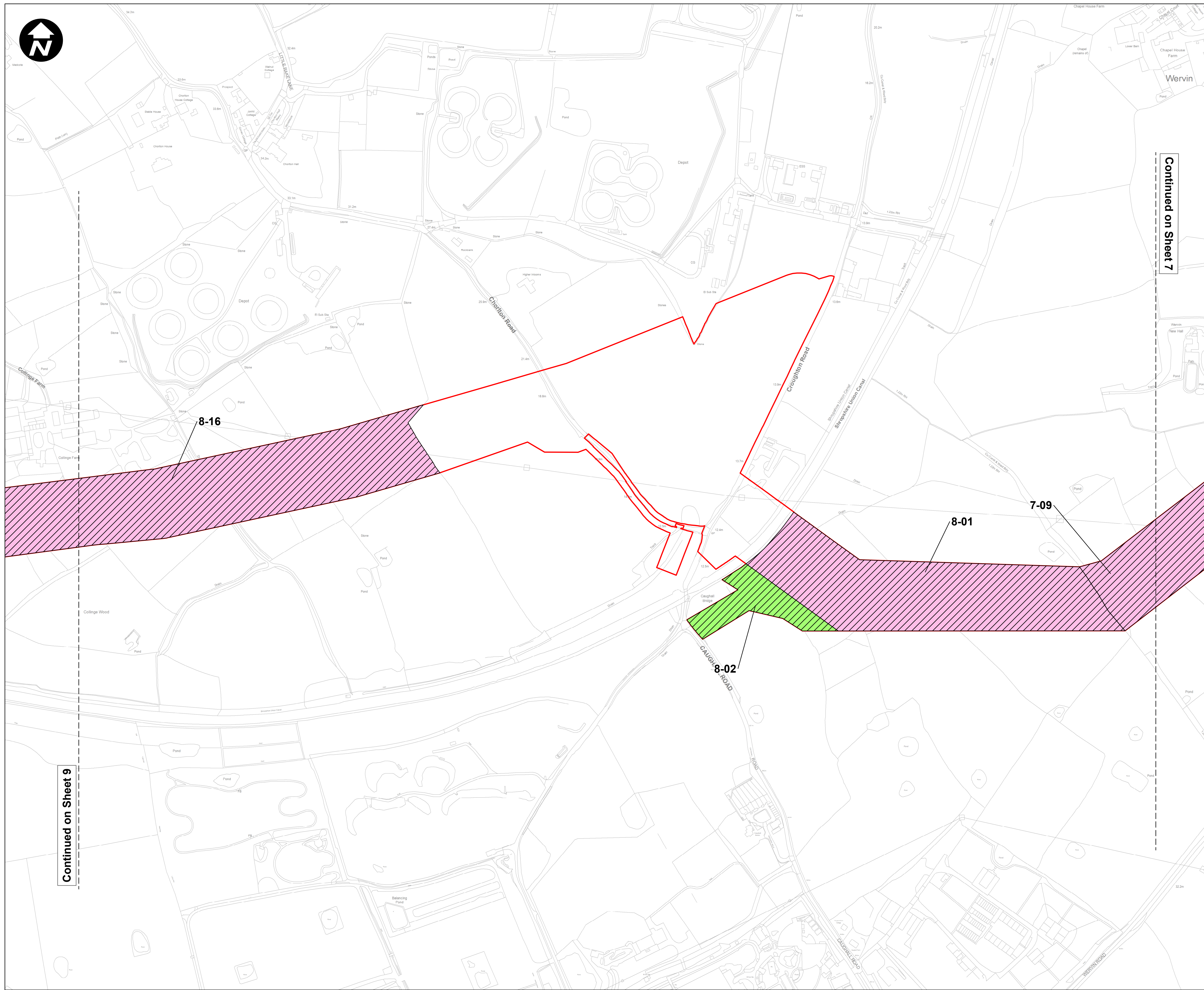

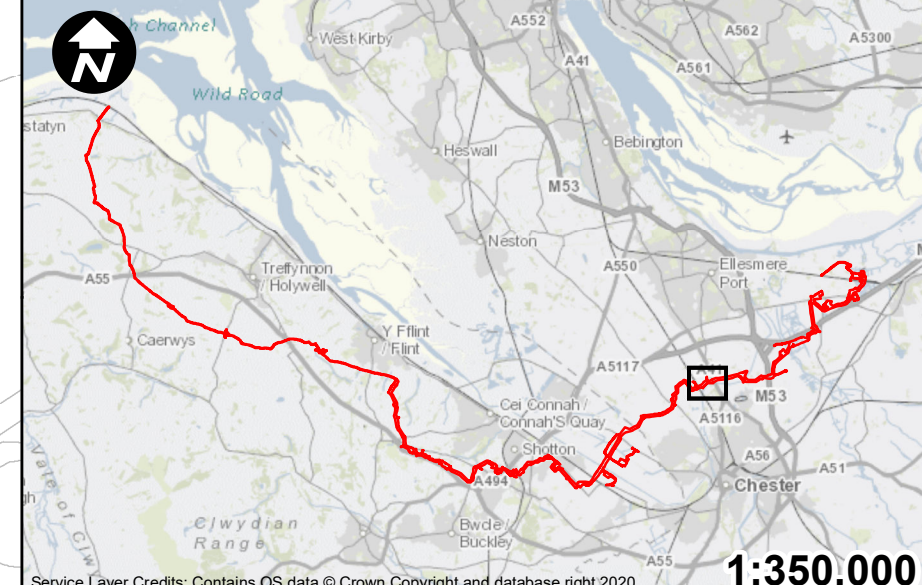

Service Layer Credits: Contains OS data © Crown Copyright and database right 2020 **1:350,000**

- Key:**
- Order Limits
 - Permanent acquisition of subsurface
 - Crown Land

1. All dimensions are in metres unless stated otherwise.
2. These Land Plans should be read in conjunction with other plans and documents in the Development Consent Order application in particular the Book of Reference.
3. All easements, servitudes and private rights in land are proposed to be extinguished on land shown coloured pink on these land plans. All easements, servitudes and private rights in land are proposed to be extinguished, so far as their continued exercise would be inconsistent with the exercise of the rights or restrictions proposed to be acquired by the undertaker on land shown coloured blue on these land plans. All easements, servitudes and private rights are proposed to be suspended while the undertaker is in temporary possession of the land shown coloured green on these land plans.
4. The number labels relate to plot numbers. Please refer to the Book of Reference for more information about these plots, including the approximate area of each plot (in square metres). Plot numbers include a reference to the relevant sheet of the Land Plans. In this numbering convention, a plot number comprises the sheet number followed by the actual plot number, e.g: Plot 01-24, where '01' is the sheet number (sheet 1) and '24' is the plot number (24 on sheet 1).

F	JH	PT	VB	26/06/2023
E	SA	PT	VB	13/06/2023
D	NC	PT	VB	18/05/2023
C	RH	PT	VB	28/02/2023
B	NC	RB	VB	13/01/2023
A	PM	JH	VB	27/09/2022

REVISION	DRAWN	CHECKED	APPROVED	DATE
SCALE: 1:2,500				

0 50 100 200 Metres

Mapping reproduced by permission of Ordnance Survey on behalf of HMSO

Contains OS data © Crown Copyright and database right 2022

HyNet North West

PROJECT TITLE
HyNet Carbon Dioxide Pipeline DCO

DRAWING TITLE
CROWN LAND PLANS REGULATION (5)(2)(n)
APPLICATION DOCUMENT REFERENCE D.2.3
SHEET 9

DRAWING STATUS
CHANGE REQUEST 3

DRAWN	CHECKED	APPROVED	AUTHORISED
RH	PT	VB	AV
SCALE @ A1 SIZE		DATE	REVISION
1:2,500		26/06/2023	F

DRAWING NUMBER
EN070007-D.2.3-CLP-Sheet 9

Continued on Sheet 10

Continued on Sheet 8

8-16

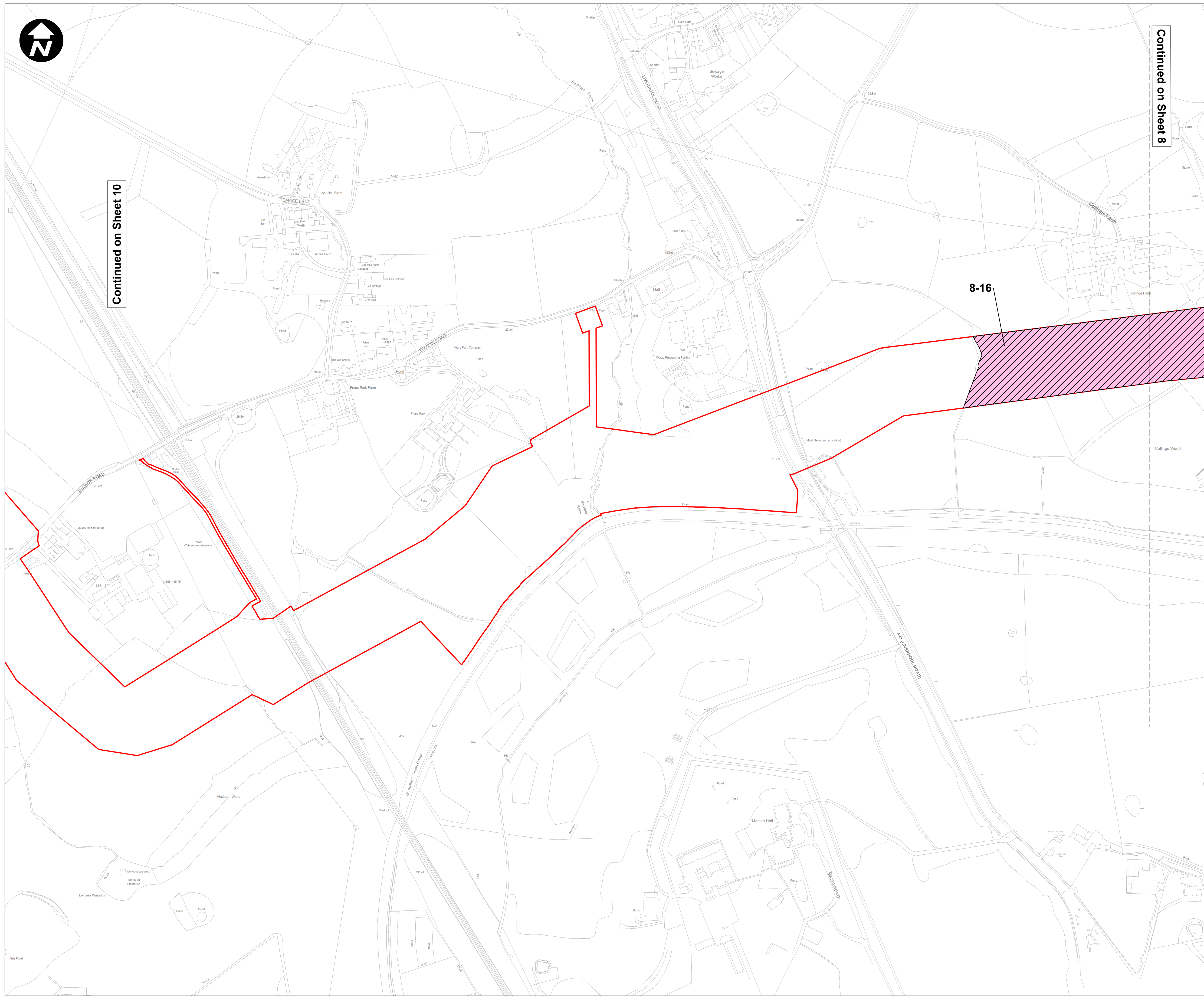

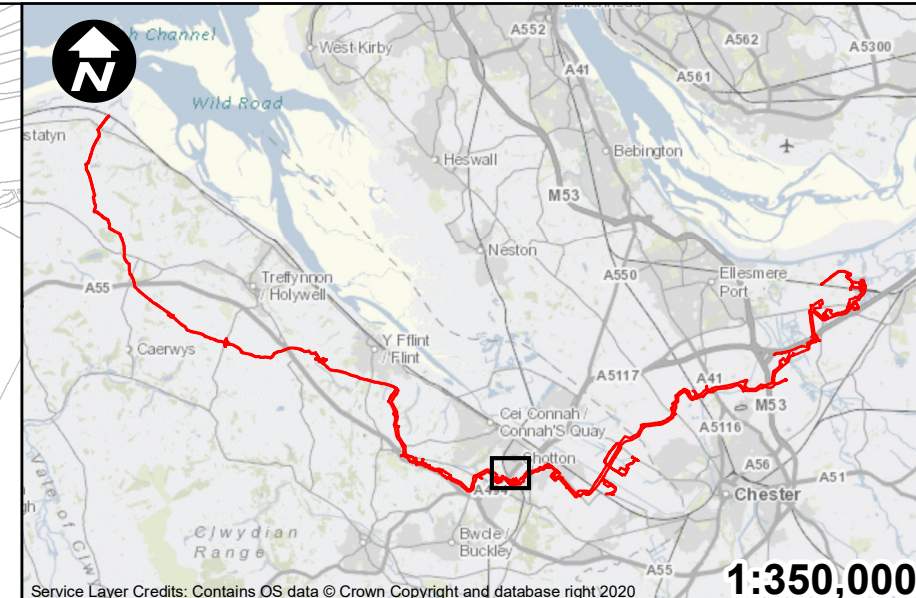
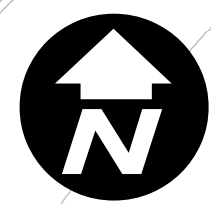

Service Layer Credits: Contains OS data © Crown Copyright and database right 2020 **1:350,000**

Key:

- Order Limits
- Permanent acquisition of subsurface
- Crown Land

1. All dimensions are in metres unless stated otherwise.
2. These Land Plans should be read in conjunction with other plans and documents in the Development Consent Order application in particular the Book of Reference.
3. All easements, servitudes and private rights in land are proposed to be extinguished on land shown coloured pink on these land plans. All easements, servitudes and private rights in land are proposed to be extinguished, so far as their continued exercise would be inconsistent with the exercise of the rights or restrictions proposed to be acquired by the undertaker on land shown coloured blue on these land plans. All easements, servitudes and private rights are proposed to be suspended while the undertaker is in temporary possession of the land shown coloured green on these land plans.
4. The number labels relate to plot numbers. Please refer to the Book of Reference for more information about these plots, including the approximate area of each plot (in square metres). Plot numbers include a reference to the relevant sheet of the Land Plans. In this numbering convention, a plot number comprises the sheet number followed by the actual plot number, e.g: Plot 01-24, where '01' is the sheet number (sheet 1) and '24' is the plot number (24 on sheet 1).

F	JH	PT	VB	26/06/2023
E	SA	PT	VB	13/06/2023
D	NC	PT	VB	18/05/2023
C	RH	PT	VB	28/02/2023
B	NC	RB	VB	13/01/2023
A	PM	JH	VB	27/09/2022
REVISION	DRAWN	CHECKED	APPROVED	DATE

SCALE: 1:2,500

0 50 100 200 Metres

Mapping reproduced by permission of Ordnance Survey on behalf of HMSO
 Contains OS data © Crown Copyright and database right 2022

HyNet North West

PROJECT TITLE
 HyNet Carbon Dioxide Pipeline DCO

DRAWING TITLE
 CROWN LAND PLANS REGULATION (5)(2)(n)
 APPLICATION DOCUMENT REFERENCE D.2.3
 SHEET 17

DRAWING STATUS
 CHANGE REQUEST 3

DRAWN RH	CHECKED PT	APPROVED VB	AUTHORISED AV
SCALE @ A1 SIZE 1:2,500		DATE 26/06/2023	REVISION F

DRAWING NUMBER
 EN070007-D.2.3-CLP-Sheet 17

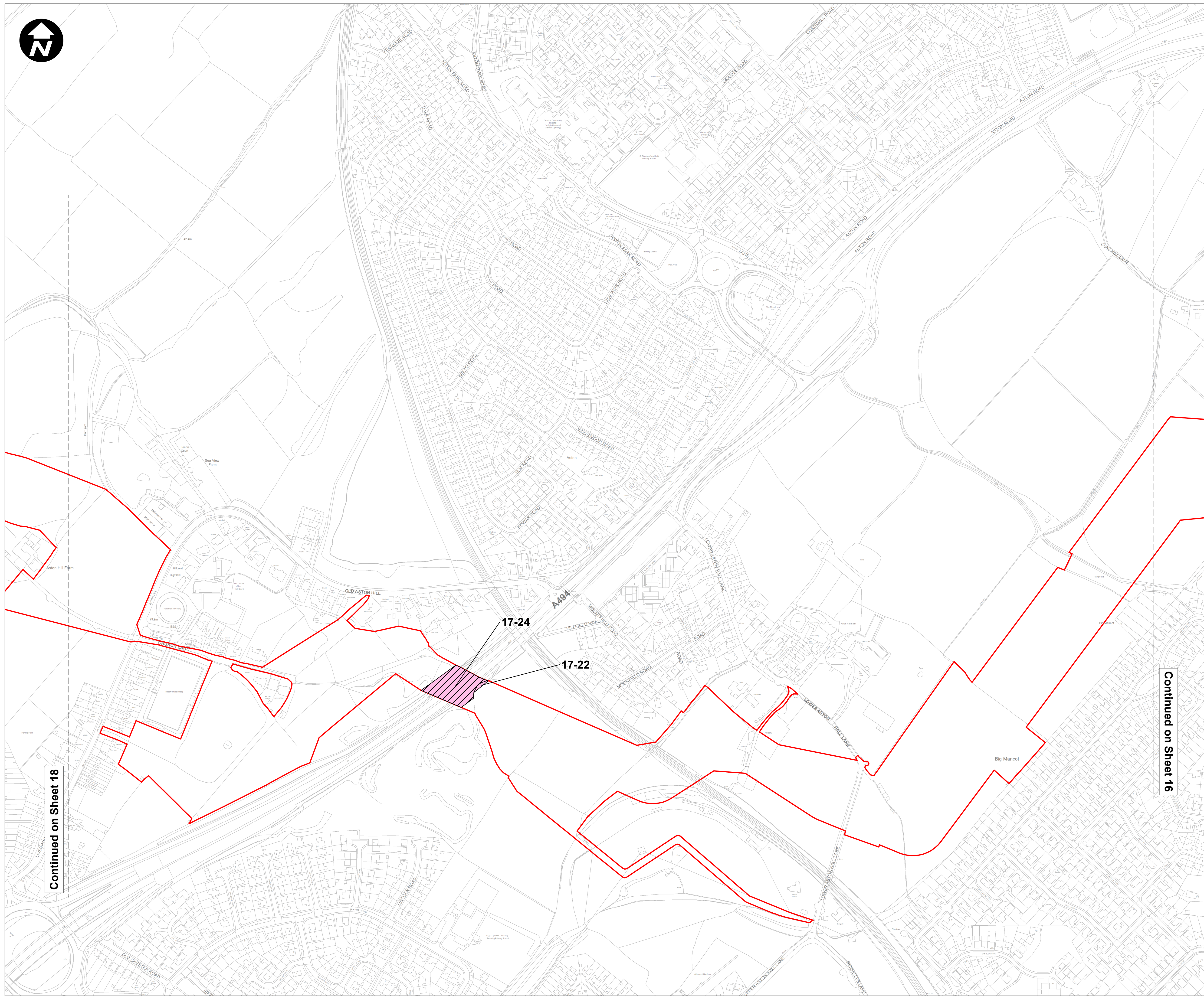

Continued on Sheet 18

Continued on Sheet 16

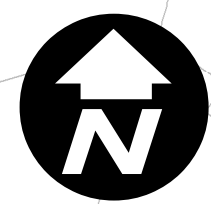

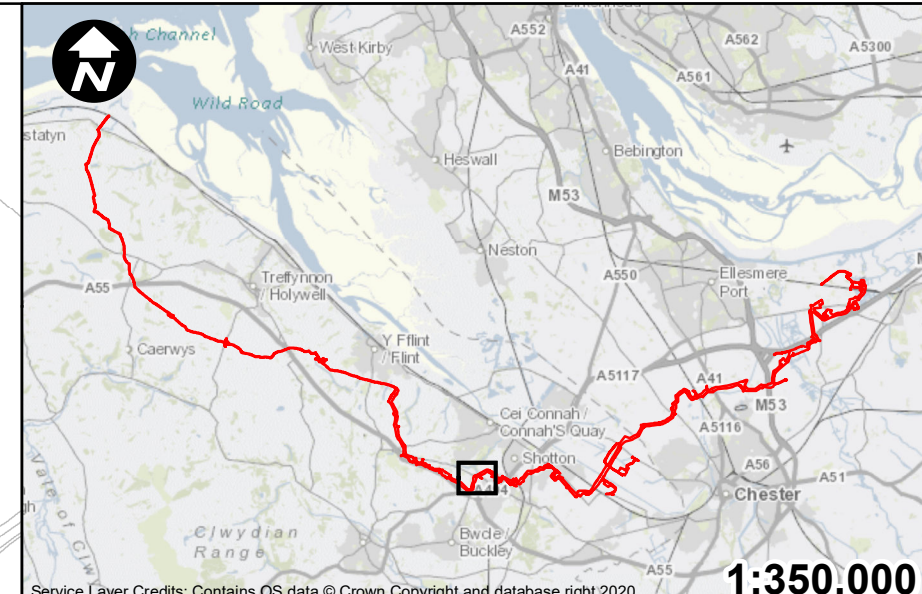

Continued on Sheet 19

Continued on Sheet 17



Service Layer Credits: Contains OS data © Crown Copyright and database right 2020 1:350,000

Key:

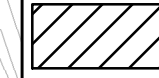
-  Order Limits
-  Permanent acquisition of subsurface
-  Crown Land

1. All dimensions are in metres unless stated otherwise.
2. These Land Plans should be read in conjunction with other plans and documents in the Development Consent Order application in particular the Book of Reference.
3. All easements, servitudes and private rights in land are proposed to be extinguished on land shown coloured pink on these land plans. All easements, servitudes and private rights in land are proposed to be extinguished, so far as their continued exercise would be inconsistent with the exercise of the rights or restrictions proposed to be acquired by the undertaker on land shown coloured blue on these land plans. All easements, servitudes and private rights are proposed to be suspended while the undertaker is in temporary possession of the land shown coloured green on these land plans.
4. The number labels relate to plot numbers. Please refer to the Book of Reference for more information about these plots, including the approximate area of each plot (in square metres). Plot numbers include a reference to the relevant sheet of the Land Plans. In this numbering convention, a plot number comprises the sheet number followed by the actual plot number, e.g: Plot 01-24, where '01' is the sheet number (sheet 1) and '24' is the plot number (24 on sheet 1).

F	JH	PT	VB	26/06/2023
E	SA	PT	VB	13/06/2023
D	NC	PT	VB	18/05/2023
C	RH	PT	VB	28/02/2023
B	NC	RB	VB	13/01/2023
A	PM	JH	VB	27/09/2022

REVISION	DRAWN	CHECKED	APPROVED	DATE
SCALE: 1:2,500				
0 50 100 200 Metres				

Mapping reproduced by permission of Ordnance Survey on behalf of HMSO
 Contains OS data © Crown Copyright and database right 2022

HyNet North West

PROJECT TITLE
HyNet Carbon Dioxide Pipeline DCO

DRAWING TITLE
 CROWN LAND PLANS REGULATION (5)(2)(n)
 APPLICATION DOCUMENT REFERENCE D.2.3
 SHEET 18

DRAWING STATUS
CHANGE REQUEST 3

DRAWN	CHECKED	APPROVED	AUTHORISED
RH	PT	VB	AV
SCALE @ A1 SIZE		DATE	REVISION
1:2,500		26/06/2023	F

DRAWING NUMBER
EN070007-D.2.3-CLP-Sheet 18

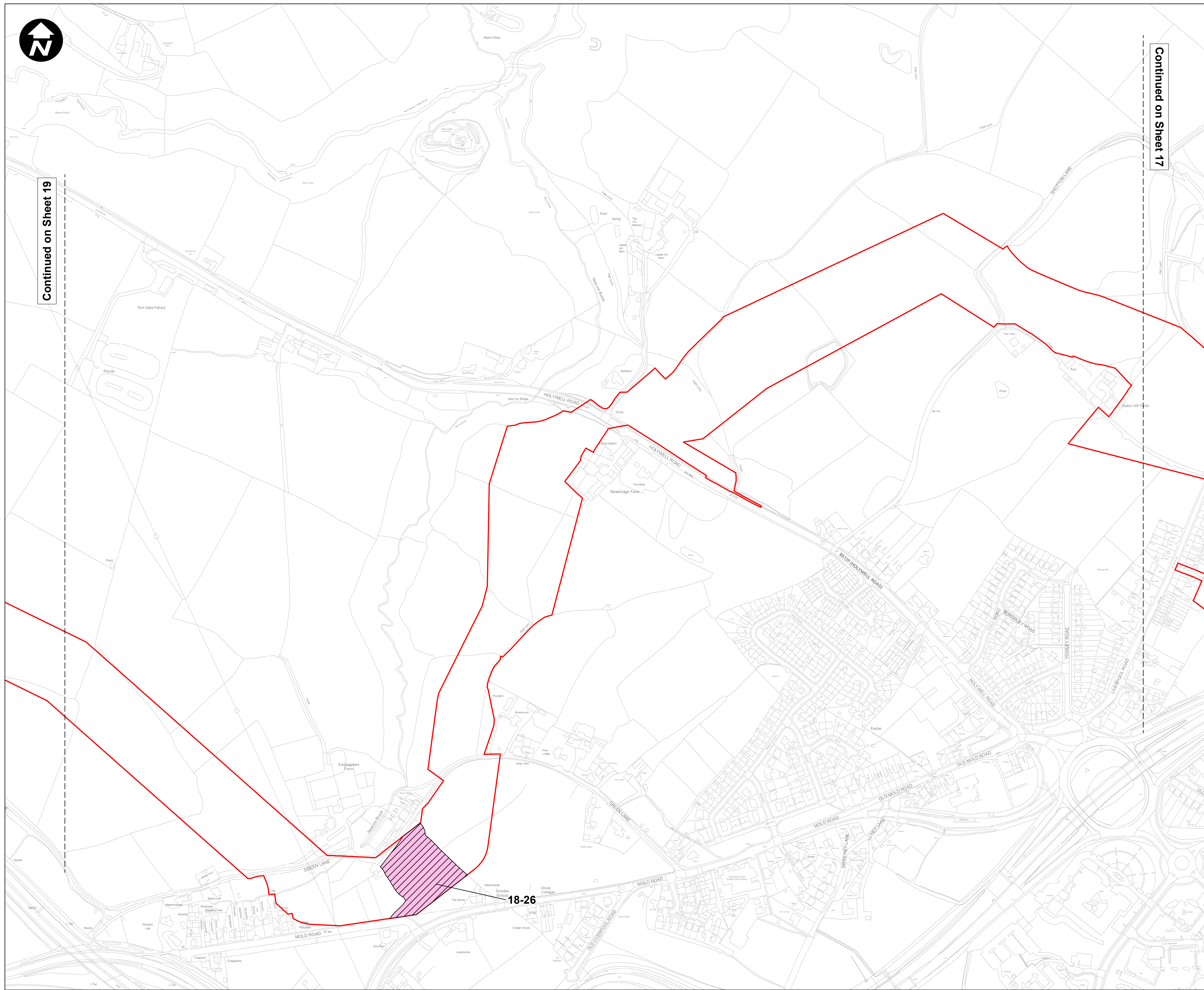

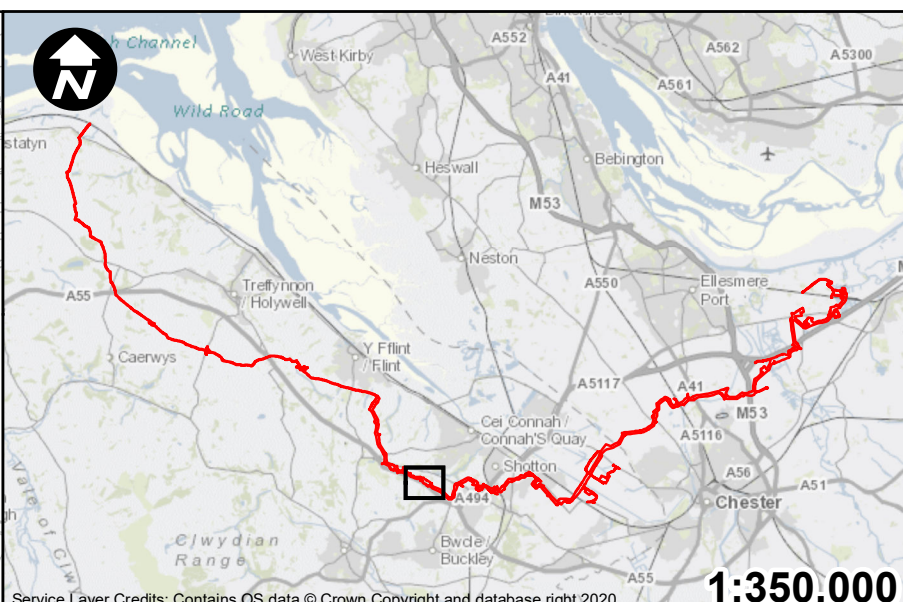
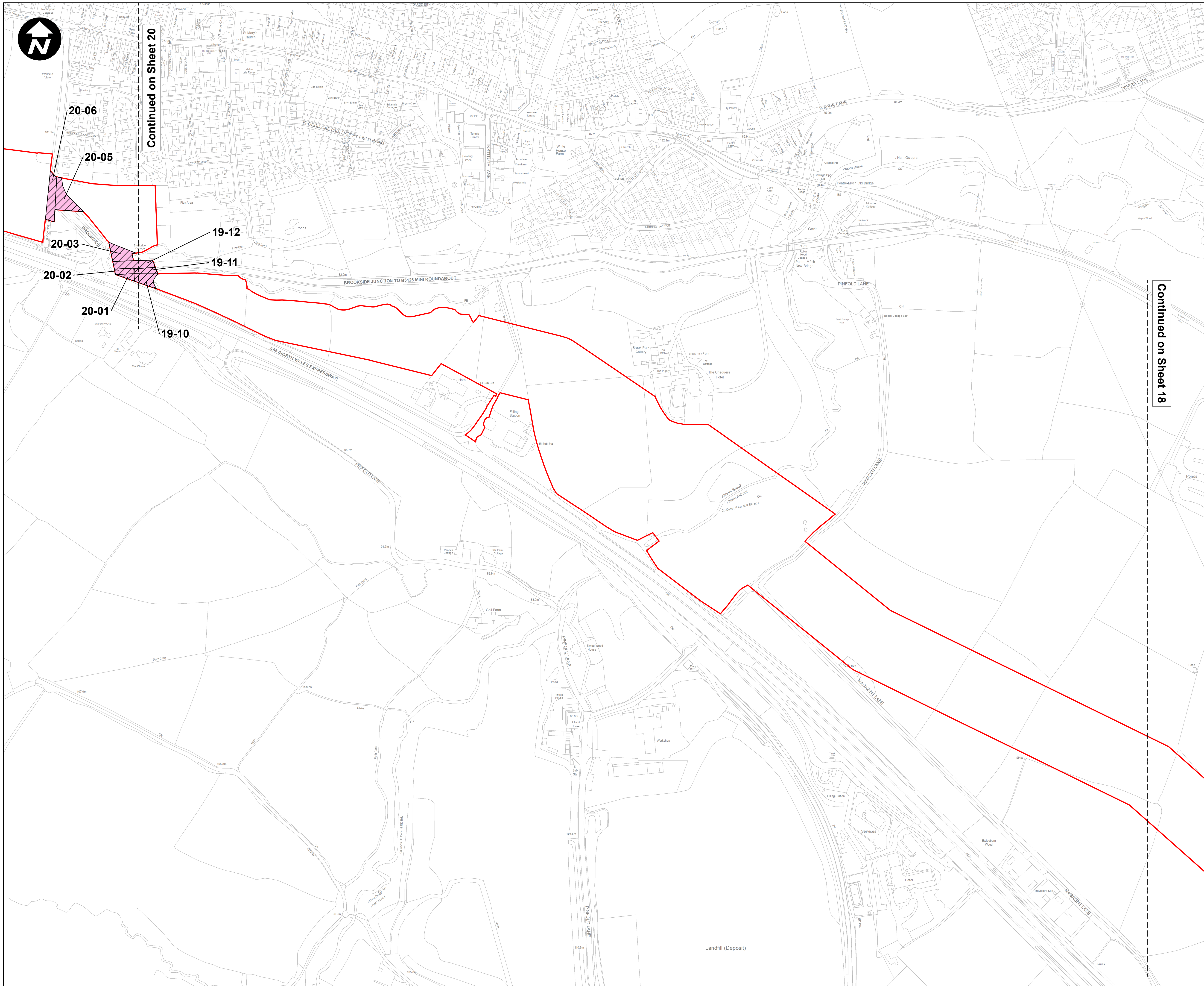

Service Layer Credits: Contains OS data © Crown Copyright and database right 2020 **1:350,000**

- Key:**
- Order Limits
 - Permanent acquisition of subsurface
 - Crown Land

1. All dimensions are in metres unless stated otherwise.
2. These Land Plans should be read in conjunction with other plans and documents in the Development Consent Order application in particular the Book of Reference.
3. All easements, servitudes and private rights in land are proposed to be extinguished on land shown coloured pink on these land plans. All easements, servitudes and private rights in land are proposed to be extinguished, so far as their continued exercise would be inconsistent with the exercise of the rights or restrictions proposed to be acquired by the undertaker on land shown coloured blue on these land plans. All easements, servitudes and private rights are proposed to be suspended while the undertaker is in temporary possession of the land shown coloured green on these land plans.
4. The number labels relate to plot numbers. Please refer to the Book of Reference for more information about these plots, including the approximate area of each plot (in square metres). Plot numbers include a reference to the relevant sheet of the Land Plans. In this numbering convention, a plot number comprises the sheet number followed by the actual plot number, e.g: Plot 01-24, where '01' is the sheet number (sheet 1) and '24' is the plot number (24 on sheet 1).

F	JH	PT	VB	26/06/2023
E	SA	PT	VB	13/06/2023
D	NC	PT	VB	18/05/2023
C	RH	PT	VB	28/02/2023
B	NC	RB	VB	13/01/2023
A	PM	JH	VB	27/09/2022
REVISION	DRAWN	CHECKED	APPROVED	DATE



Mapping reproduced by permission of Ordnance Survey on behalf of HMSO
 Contains OS data © Crown Copyright and database right 2022



PROJECT TITLE
HyNet Carbon Dioxide Pipeline DCO

DRAWING TITLE
 CROWN LAND PLANS REGULATION (5)(2)(n)
 APPLICATION DOCUMENT REFERENCE D.2.3
 SHEET 19

DRAWING STATUS
CHANGE REQUEST 3

DRAWN	CHECKED	APPROVED	AUTHORISED
RH	PT	VB	AV
SCALE @ A1 SIZE		DATE	REVISION
1:2,500		26/06/2023	F

DRAWING NUMBER
 EN070007-D.2.3-CLP-Sheet 19

Continued on Sheet 20

Continued on Sheet 18

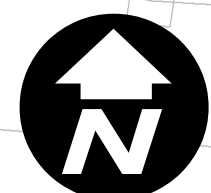

Continued on Sheet 23

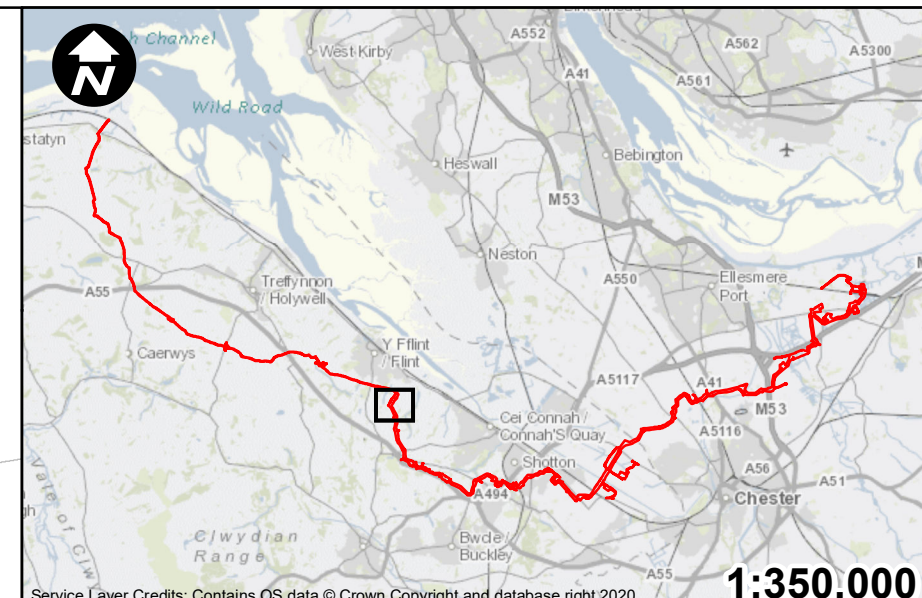

Service Layer Credits: Contains OS data © Crown Copyright and database right 2020 1:350,000

- Key:**
- Order Limits
 - Permanent acquisition of land
 - Permanent acquisition of subsurface
 - Temporary possession of land
 - Crown Land

1. All dimensions are in metres unless stated otherwise.
2. These Land Plans should be read in conjunction with other plans and documents in the Development Consent Order application in particular the Book of Reference.
3. All easements, servitudes and private rights in land are proposed to be extinguished on land shown coloured pink on these land plans. All easements, servitudes and private rights in land are proposed to be extinguished, so far as their continued exercise would be inconsistent with the exercise of the rights or restrictions proposed to be acquired by the undertaker on land shown coloured blue on these land plans. All easements, servitudes and private rights are proposed to be suspended while the undertaker is in temporary possession of the land shown coloured green on these land plans.
4. The number labels relate to plot numbers. Please refer to the Book of Reference for more information about these plots, including the approximate area of each plot (in square metres). Plot numbers include a reference to the relevant sheet of the Land Plans. In this numbering convention, a plot number comprises the sheet number followed by the actual plot number, e.g: Plot 01-24, where '01' is the sheet number (sheet 1) and '24' is the plot number (24 on sheet 1).

F	JH	PT	VB	26/06/2023
E	SA	PT	VB	13/06/2023
D	NC	PT	VB	18/05/2023
C	RH	PT	VB	28/02/2023
B	NC	RB	VB	13/01/2023
A	PM	JH	VB	27/09/2022
REVISION	DRAWN	CHECKED	APPROVED	DATE

SCALE: 1:2,500

Mapping reproduced by permission of Ordnance Survey on behalf of HMSO
 Contains OS data © Crown Copyright and database right 2022

HyNet North West

PROJECT TITLE
HyNet Carbon Dioxide Pipeline DCO

DRAWING TITLE
 CROWN LAND PLANS REGULATION (5)(2)(n)
 APPLICATION DOCUMENT REFERENCE D.2.3
 SHEET 22

DRAWING STATUS
CHANGE REQUEST 3

DRAWN	CHECKED	APPROVED	AUTHORISED
RH	PT	VB	AV

SCALE @ A1 SIZE	DATE	REVISION
1:2,500	26/06/2023	F

DRAWING NUMBER
 EN070007-D.2.3-CLP-Sheet 22

22-04

22-10

22-08

22-09

22-07

22-06

Continued on Sheet 21

